

SEE SHEET 4

BOROUGH OF WEST CALDWELL
ESSEX COUNTY

BOROUGH OF WEST CALDWELL
ESSEX COUNTY

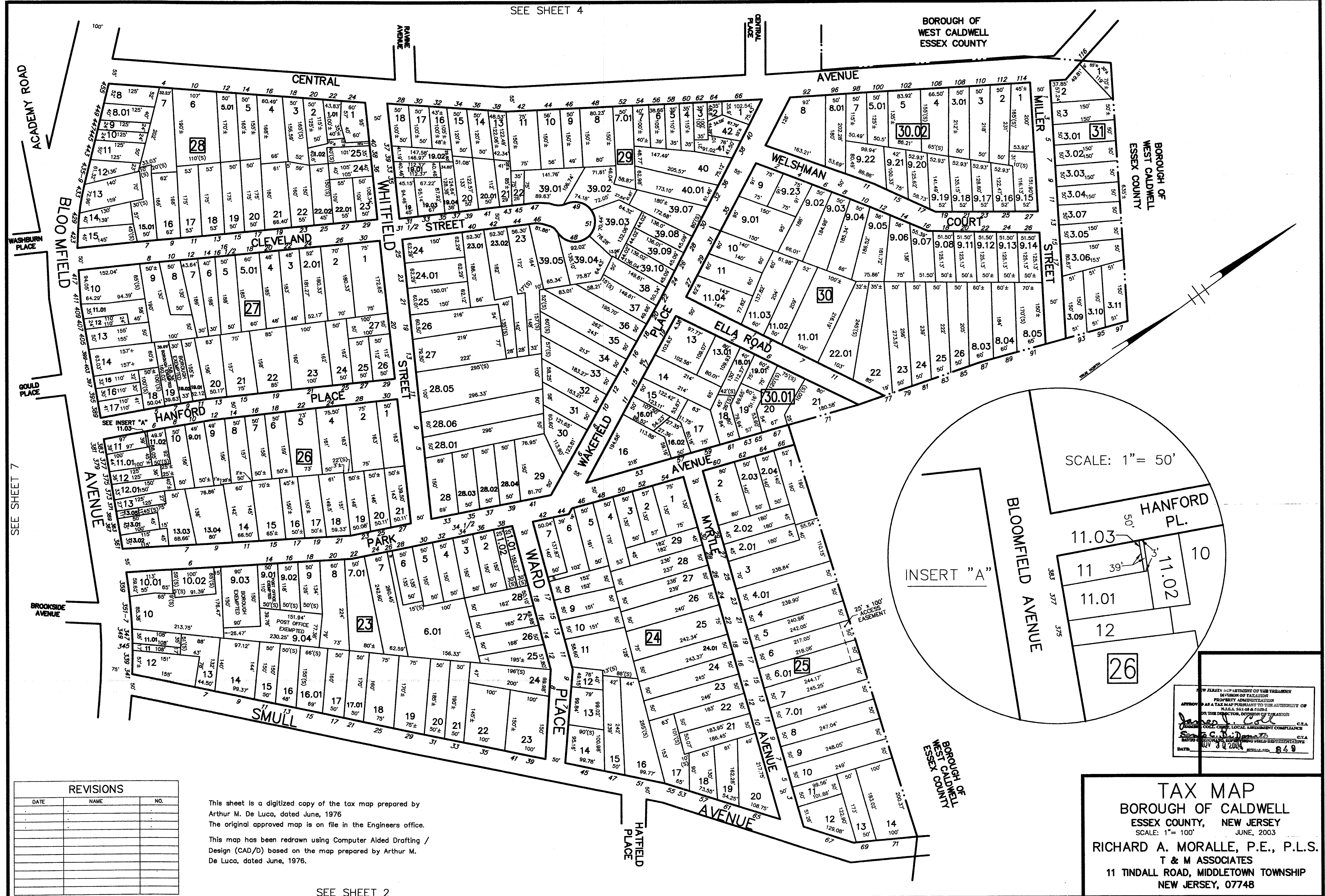

SEE SHEET 7

REVISIONS		
DATE	NAME	NO.

This sheet is a digitized copy of the tax map prepared by Arthur M. De Luca, dated June, 1976. The original approved map is on file in the Engineers office. This map has been redrawn using Computer Aided Drafting / Design (CAD/D) based on the map prepared by Arthur M. De Luca, dated June, 1976.

SEE SHEET 2

NEW JERSEY DEPARTMENT OF THE TREASURY
DIVISION OF TAXATION
PROPERTY ADMINISTRATOR
APPROVED AS A TAX MAP PURSUANT TO THE AUTHORITY OF
N.J.A.C. 17:27 AND 17:28
BY THE DIRECTOR, DIVISION OF TAXATION
James P. [Signature] C.T.A.
JAMES P. [Signature] C.T.A.
DATE: 06/08/2004

TAX MAP
BOROUGH OF CALDWELL
ESSEX COUNTY, NEW JERSEY
SCALE: 1" = 100' JUNE, 2003
RICHARD A. MORALLE, P.E., P.L.S.
T & M ASSOCIATES
11 TINDALL ROAD, MIDDLETOWN TOWNSHIP
NEW JERSEY, 07748